

**VAI SERIES
AMPLIFIED KEYPAD IR VOLUME
CONTROL SYSTEM IDEAL FOR
MULTI-ROOM AUDIO
DISTRIBUTION**

**Experiment how Chiefdom's VAI SERIES
with employ of infrared distributes your
favorite audio throughout the house for
the enjoyment of home audio everywhere
in the most cost - effective & convenient
way ~**

PARTS LIST

VAI-3107

One gang infrared amplified Keypad

simultaneously employ the infrared to get remote control the volume of the built-in amplifier from level 0 –31 as LCD display

Power handling: RMS 6W per channel



PARTS LIST

SSI-0103

MAIN SINGLE SOURCE INPUT

- * elementary part with other available options (see page 8)
- * With power jack at the front
- * Input connections: 1 pair of 2 color coated stereo RCA jacks
- * 50K ohms input impedance
- * Output connections: (3) sets of (4) 110 punch down connectors, Left, Right, GND, and + VDC



PARTS LIST

SSI-0202

LOCAL(ROOM) SOURCE INPUT

- *unique but optional
- *Without need of power input
- *Input connections: 2 pairs of 2 color-coated stereo RCA jacks
- *50K ohms input impedance
- *Output connections: (2) sets of (4) 110 punch down connectors, Left, Right, GND, and + VDC
- *two slide switches for selection of room source from main or local.



PARTS LIST

RMC-104

**Customized IR Remote
Control**

*elementary part

*functions of power

on/off, volume up & down

*Dimension:

0.3"H x 2.2" W x 3.5"L



PARTS LIST

PWS-2440

SWITCHING POWER

- *elementary part but you can have your own alternative
- *Input: Auto range 100-240 VAC/
47-63 HZ Current: 1.9A Max
- *Output: +24V/0-4A
- *Dimension: 1.7"H x 2.4"Wx6.0" L
- *Accommodate the power for 4units of VAI-3107



ALTERNATIVE PART

VAI3107S200

2-Gang Amplified IR

Keypad+local source input

Power handling:

6W(RMS) per channel

LCD numeral display for volume

level 0-31 to be controlled

either by remote or keypad

Local source inputs available from

2 pairs of 2 color-coated stereo

RCA jacks



APPLICATION for A 4-ZONES AUDIO DISTRIBUTION with SELECTIONS OF 1 MAIN SOURCE+2 ROOM SOURCE

Elementary parts containing below:

1unit of SSI-0103 + 4 units of VAI-3107 + 1unit of SSI-0202 + 4units of RMC-104 + 1unit of PWS-2440

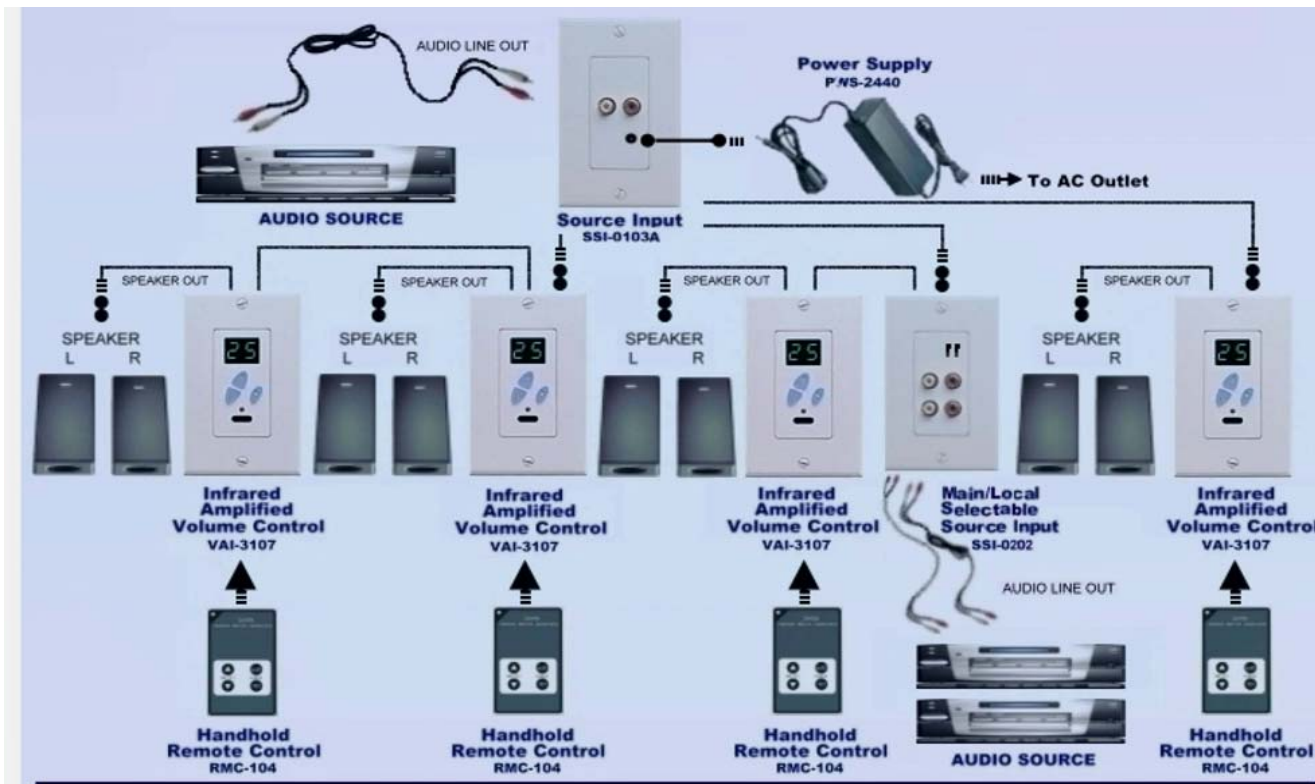

INSTALLATION for 4-ZONE AUDIO DISTRIBUTION

MAIN SOURCE INPUT

for further connection to your sound
player like as CD player, MP3, IPOD

Powered by switching power PWS-2440

4 AVAILABLE OPTIONS

- a) SSI-0103A (left top per photo shown)
main single source input with power jack
at the front
- b) SSI-0303 (middle top per photo shown)
main multi-source input with power jack
at the back
- c) SSI-0203A (right top per photo shown)
main multi-source input with power jack
at the front
- d) SSI-0103 (middle bottom per photo)
main single source input with power jack at the back



INSTALLATION for 4-ZONE AUDIO DISTRIBUTION

ZONE 1 + 2

Each zone contains

VAI-3107 1unit

for further assembling with your pair
of speakers

RMC-104 1unit

optional for get remote control of
the volume of VAI-3107



INSTALLATION for 4-ZONE AUDIO DISTRIBUTION

ZONE 3

Same as ZONE 1+ 2

This zone contains

VAI-3107 1unit

for further assembling with your pair
of speakers

RMC-104 1unit

optional for get remote control of
the volume of VAI-3107



INSTALLATION for 4-ZONE AUDIO DISTRIBUTION

ZONE 4 with optional installation of room source input

This zone contains following parts

VAI-3107 1unit

for further assembling with your pair of
speakers

SSI-0202 1unit

for installation with your available sound player
like as CD player, MP3, IPOD.

RMC-104 1unit

optional for get remote control of
the volume of VAI-3107



INSTALLATION for 4-ZONE AUDIO DISTRIBUTION

**ALTERNATIVE ZONE 4 set up by
part no. VAI3107S200 as
a combined 2-gang amplified IR
keypad+room source input**

This zone contains following parts

VAI3107S200 1unit

*for further assembling with your pair of speakers

*for connection to your available sound player
like as CD player, MP3, IPOD for a room(local) source
input

RMC-104 1unit

optional for get remote control of
the volume of VAI-3107



WHY CHIEFDOM'S VAI SERIES

Built- in amplified keypad + source input for simply connect to line out audio devices additionally employ of infrared as being so convenient & economic way to enjoy and enhance your favorite audio throughout the house ~