

Rotary Switch

RCL 371 SERIES



適用於：

1. 多迴路、多接點的切換選擇
2. 電腦周邊，資料轉換器用開關
3. PA大樓廣播系統
4. HI END 高級音響音量控制
5. 通訊器材
6. 各類儀器選用

APPLICABLE TO :

1. Function selection of multi-section, multi-pole, multi-position (2-12 positions) products.
2. Computer peripheral product-data transfer switch.
3. Public audio system.
4. Volume control of Hi-End audios.
5. Communication equipments.
6. Function selection of instruments machines.

特性規格 SPECIFICATION

項目 ITEM	
定 格 RATING	DC 30V 0.5A
接觸電阻 CONTACT RESISTANCE	25mΩ MAX
絕緣電阻 INSULATION RESISTANCE	DC 500V 100MΩ MIN
耐 電 壓 WITHSTAND VOLTAGE	500V 1 MINUTE
動 作 力 TORQUE	1 TO 3 SECTION 2±1kg (REFERENCE) OVER 3 SECTION 3±1.5kg

多層式組合開關之層數，迴路數，段數及本體長之互動說明 ILLUSTRATION OF MULTI-SECTION SWITCHES'S POLE. POSITION AND BODY LENGTH (mm)

層數(1~12) SECTION	迴路數 POLE	段數(2~12) POSITIONS	L (本體長) BODY LENGTH	層數(1~12) SECTION	迴路數 POLE	段數(2~12) POSITIONS	L (本體長) BODY LENGTH
1	8	2	3.6 mm	5	40	2	18 mm
	4	3			20	3	
	3	4			15	4	
	2	5~6			10	5~6	
	1	7~12			5	7~12	
2	16	2	7.2 mm	7	56	2	25.2 mm
	8	3			28	3	
	6	4			21	4	
	4	5~6			14	5~6	
	2	7~12			7	7~12	
3	24	2	10.8 mm	9	36	3	32.4 mm
	12	3			27	4	
	9	4			18	5~6	
	6	5~6			9	7~12	
	3	7~12					
4	28 or 32	2	14.4 mm	12	48	3	43.2 mm
	16	3			36	4	
	12	4			24	5~6	
	8	5~6			12	7~12	
	4	7~12					
				1~12 SECTIONS			SECTIONS ×3.6 mm

Rotary Switch

RCL 371 SERIES

2 Position Series

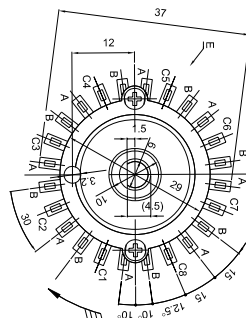
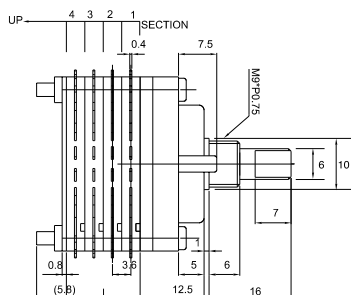

3 Position Series

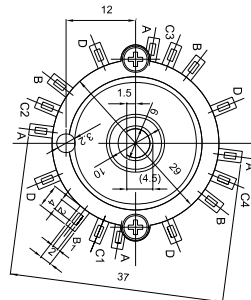
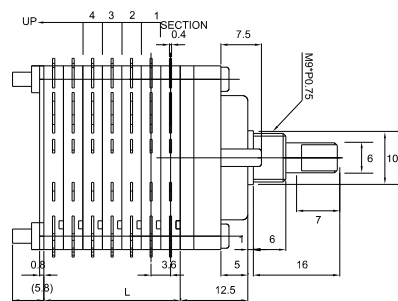
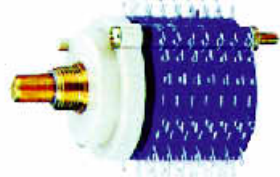

4 Position Series

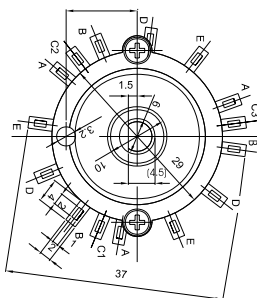
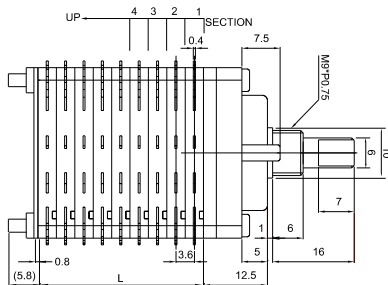
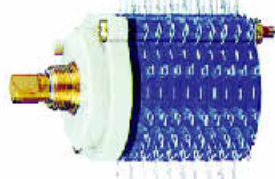

Rotary Switch

RCL 371 SERIES

5~6 Position Series

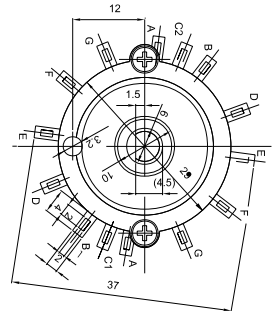
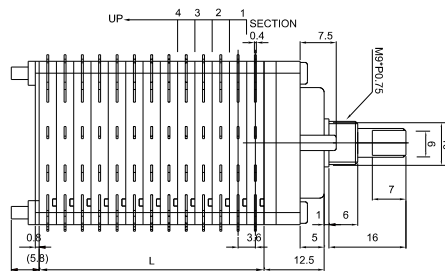

7~12 Position Series

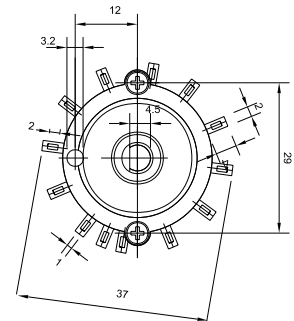
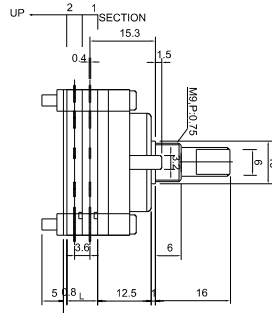

X Position Series

